



Installation

Model specific instructions

For:

- [Ducati Multistrada 620](#)
- [Ducati Multistrada 1000 DS](#)
- [Ducati Multistrada 1000 DSS](#)
- [Ducati Multistrada 1100](#)
- [Ducati Multistrada 1100 S](#)

These instructions are a model specific add-on to the general BoosterPlug installation instructions.

The general BoosterPlug installation instructions can be found in the "Downloads" section on the [BoosterPlug.com](http://www.boosterplug.com) website:

<http://www.boosterplug.com/shop/cms-downloads.html>

Installation Tips

- Install the BoosterPlug module as per the general installation papers.
- The pictures below should help you locate the AIT sensor where the BoosterPlug is installed.
- The AIT sensor is located inside the front fairing on the left hand side.
- The BoosterPlug sensor cable is short because the sensor is already in the right spot, right next to the original sensor.

Pictures

For:

- [Ducati Multistrada 620](#)
- [Ducati Multistrada 1000 Series](#)
- [Ducati Multistrada 1100 Series](#)

MULTISTRADA 1100

drawing 019 Electrical system

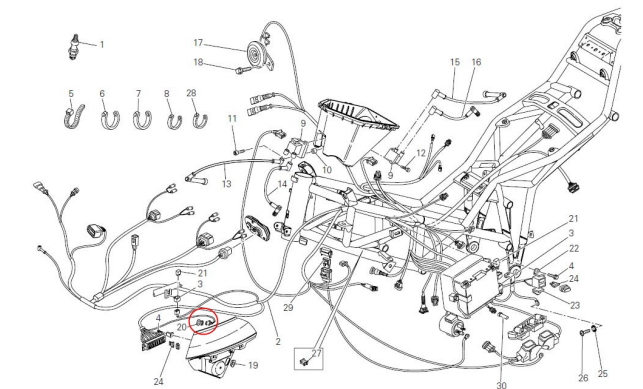

MULTISTRADA 1000 DS

drawing 019a Front wiring

